

## SPECIFICATION FOR APPROVAL

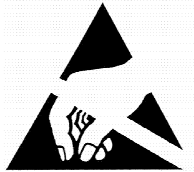

**ATTENTION**  
OBSERVE PRECAUTIONS  
FOR HANDLING  
ELECTROSTATIC  
DISCHARGE  
SENSITIVE  
DEVICES

HL-SW3N12B25-V3 PURE WHITE



### Features

- Bulb Type: 3\*1W GU10 LED Spotlight
- Input Voltage : AC 100~240V 50/60HZ
- Beam Angle: 38°
- Light Source: 3\*1W high power LED
- Body Temperature: <70°C(environment temperature 30°C)
- Net Weight: 48g
- Aluminum alloy heat-sink
- Can use electronic transformer as power supply

### Dimensions

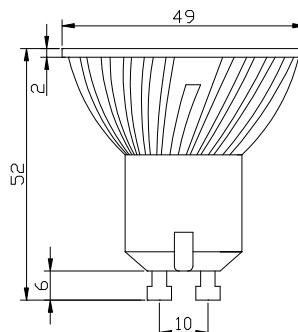
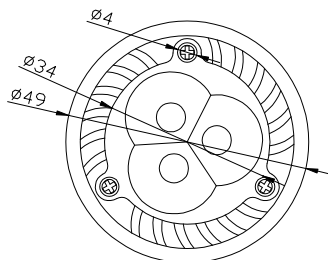

#### Notes:

1. All dimension units are millimeters.
2. All dimension tolerance is  $\pm 1$ mm unless otherwise noted.

**Absolute Maximum Rating at TA=25°C**

Parameter	Symbol	Absolute Maximum Rating	Unit
Power supply voltage AC	V <sub>IN</sub>	240	V
Power Dissipation	PD	4.5	W
Electrostatic discharge	ESD	800	V
Operating Temperature	Topr	-20□+40	□
Storage Temperature	Tstg	-40□+60	□

**Electrical / Optical Characteristics at TA=25°C**

Parameter	Symbol	Condition	Min	Typ	Max	Unit
Input Voltage AC	V <sub>IN-AC</sub>	50/60HZ	100	220	240	v
Color Temperature	TC	V <sub>IN</sub> =220V DC	5000	--	8000	K
Luminous flux	Φ <sub>v</sub>	V <sub>IN</sub> =220V DC	95	130	--	lm
Illuminance( distance of 1 meter )	E	V <sub>IN</sub> =220V DC	--	500	--	LUX

Notes:Tolerance of measurement of luminous intensity±15%.

**NOTES**

- ONLY FOR INDOOR USE.
- SHOULD NOT BE USED IN ENCLOSDE ENVIRONMENT.
- IT'S NOT ALLOWED TO BE USED IN CORROSIVE ENVIRONMENT.
- WORKING ENVIRONMENT TEMPERATURE SHOULD BE WITHIN -20°C~40°C, AND ENVIRONMENT HUMIDITY SHUOLD BE LESS THAN 80%.
- DON'T TOUCH IT WHEN IT HAS BEEN WORKING FOR A LONG TIME.
- POWER SUPPLY SHOULD BE SWITCHED OFF WHEN THIS PRODUCT IS BEING INSTALLED OR REPLACED.

**Package means**

