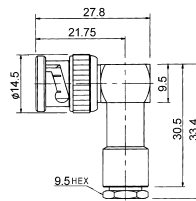
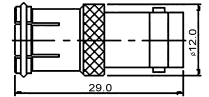

M55755

Right angle BNC male clamp type gold-pin
(RG58U/59U)

**M55767**

BNC female to PAL female

**M55756**

BNC female chassis mount clamp type gold-pin
(RG58U/59U)

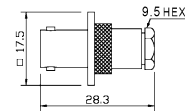
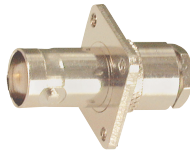
**M55771**

BNC female panel mount gold-pin

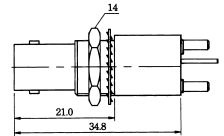
**M55758**

Right angle BNC female bulkhead gold-pin

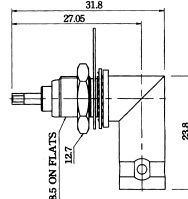
**M55758T**

Right angle BNC female bulkhead gold-pin
teflon insulation

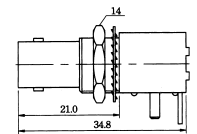
**M55760**

BNC female chassis mount crimp type gold-pin
(RG58U/59U)

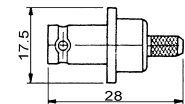
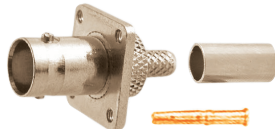
**M557740**

BNC female bulkhead long thread gold-pin

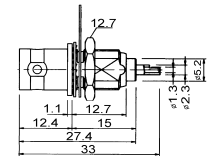
**M55762**

Double BNC female chassis mount gold-pin

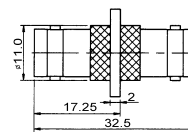
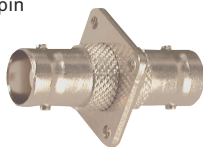
**M55776**

Right angle BNC male crimp type gold-pin (RG58U/59U)

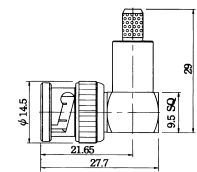
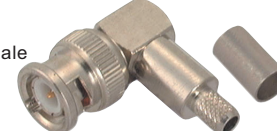
**M55776T**

Right angle BNC male crimp type gold-pin
(RG58U/59U)
teflon insulation

M55763

Double BNC female gold-pin

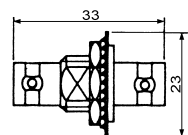
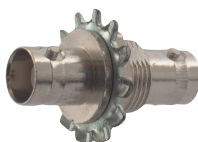
**M55778**

BNC female PCB mount gold-pin

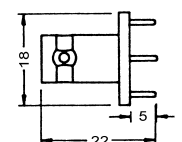
**M55764**

BNC female to TNC female gold-pin

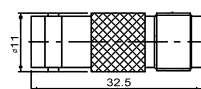
**M55779**

Right angle BNC female PCB mount gold-pin

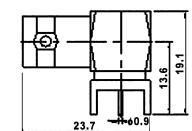
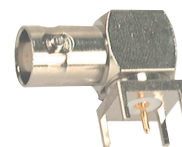
**M55765**

BNC male to PAL male

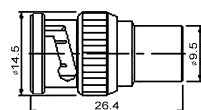
**M55780**

Double BNC female bulkhead gold-pin
(isolated ground)

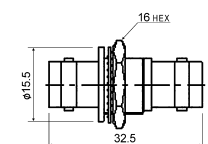
**M55766**

BNC male to PAL female

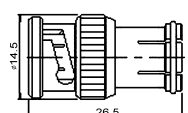
**M55781**

Protective cap for BNC female

