

tend PILOT LAMP (TN2 ϕ 22/ ϕ 25/ ϕ 30) DIRECT POWER

TN2

This series of bulbs used are same as those for direct type illuminated push button switch. see p. 6

MODEL DESIGNATION

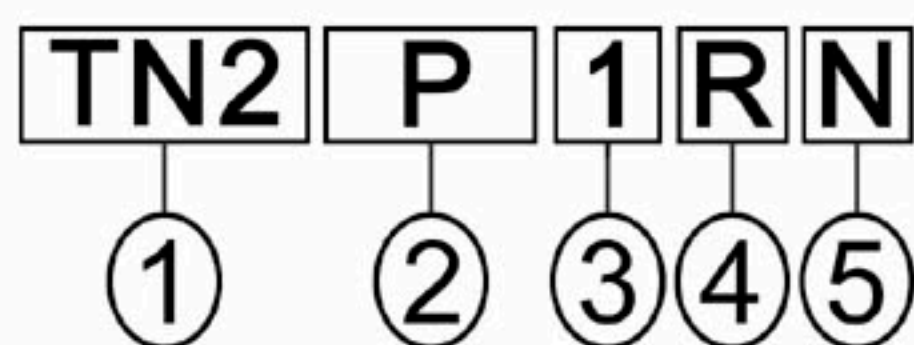

Designation	Signal	Description
1.Mounting Hole	TN2 TN3	ϕ 22mm/ ϕ 25mm ϕ 30mm
2.Type	P L N D	Direct Power Simple(Screw Terminal in the rear) Simple(Screw Terminal on the side) Big LED

Designation	Signal	Description
3.Voltage	1	110VAC (Neon.LED Bulb)
	2	220VAC (Neon.LED Bulb)
	3	380VAC (Neon Bulb)
	4	440VAC (Neon Bulb)
	5	6V AC/DC (Incandescent.LED Bulb)
	6	18V AC/DC(Incandescent)
	7	24V AC/DC(Incandescent.LED Bulb)
	8	30V AC/DC(Incandescent.LED Bulb)
	9	12V AC/DC(Incandescent)
4.Lens Color	R	Red
	G	Green
	O	Orange
	W	White
	BL	Blue
5.Lamp	YG	Olivine
	I	Neon Bulb
	N	Filament Bulb
	L	LED Bulb

PILOT LAMP(DIRECT POWER)DIMENSIONS

TN2P

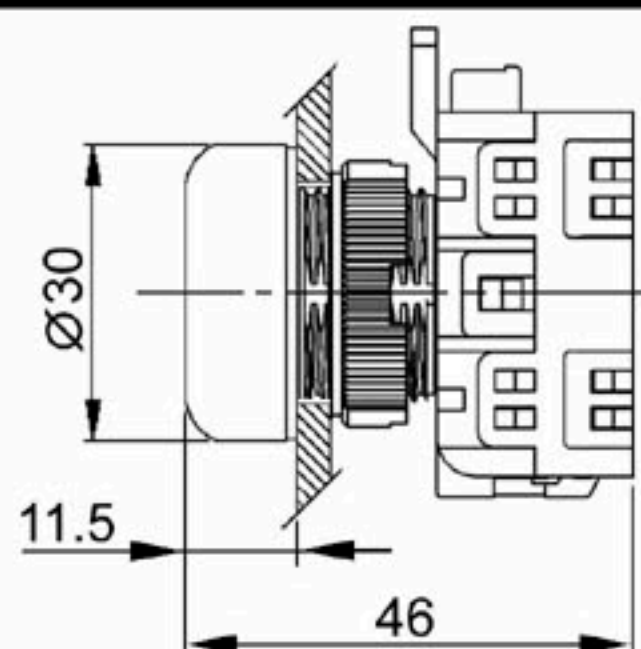

TN3P

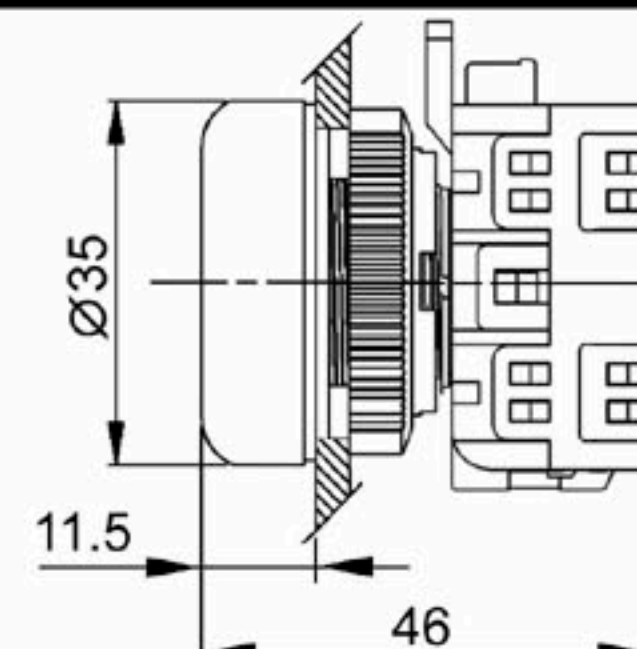

TN2L

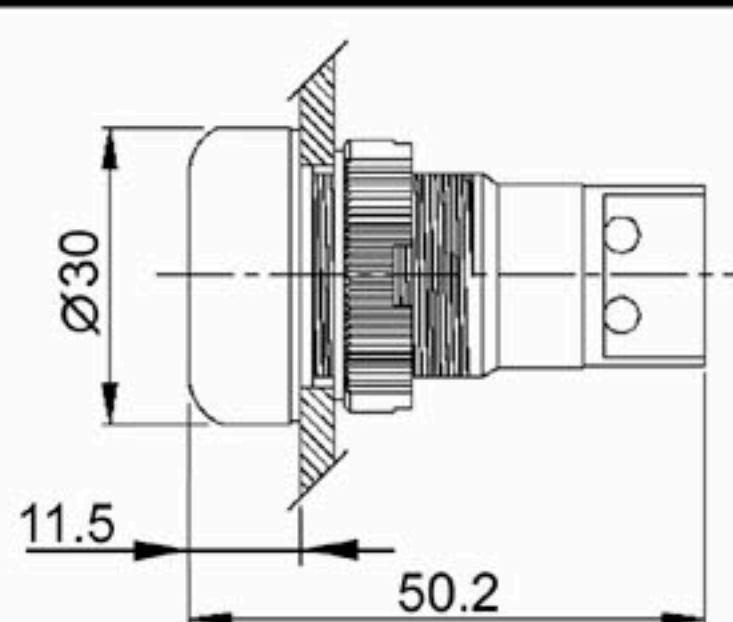

TN3L

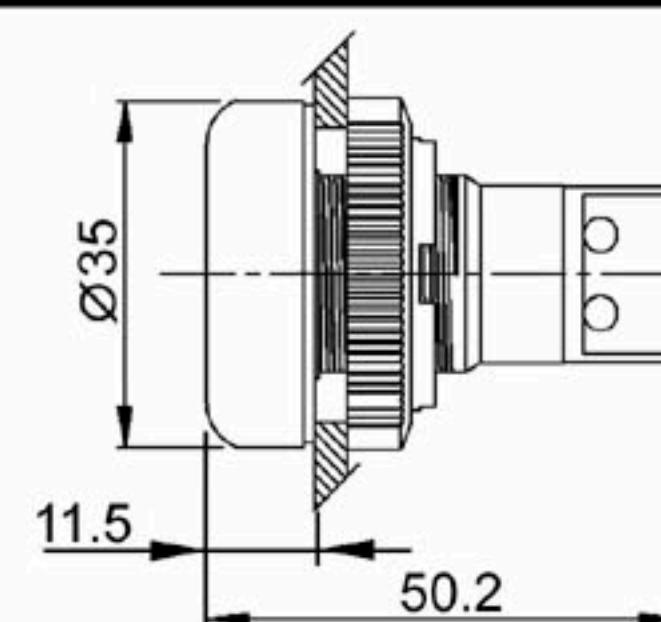

TN2N

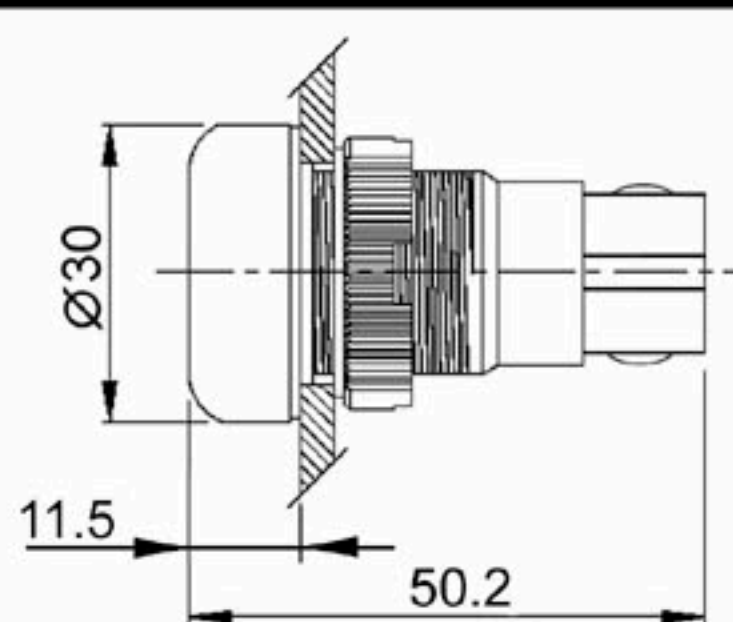

TN3N

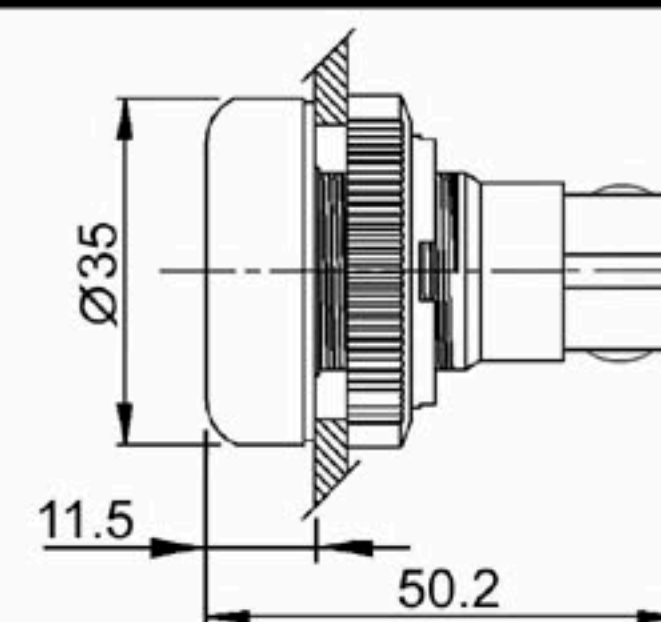

TN2D

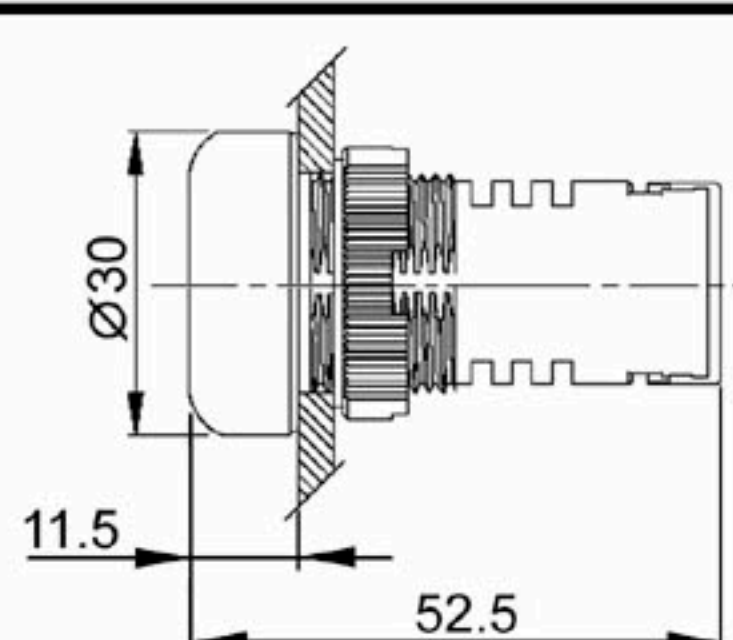

TN3D

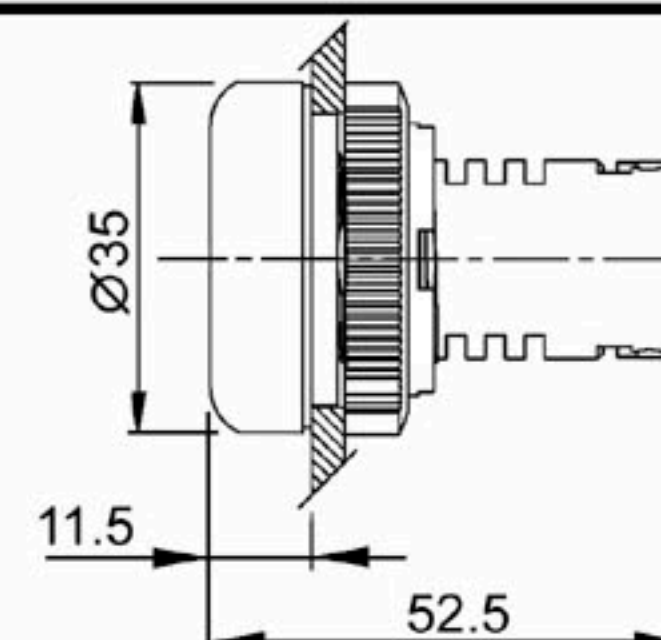

LAMP HOLDER BLOCKS(DIRECT POWER)

TNPS - 1

